

WIRE ROPE
LIFTING LOOP
1600 LBS (4x)

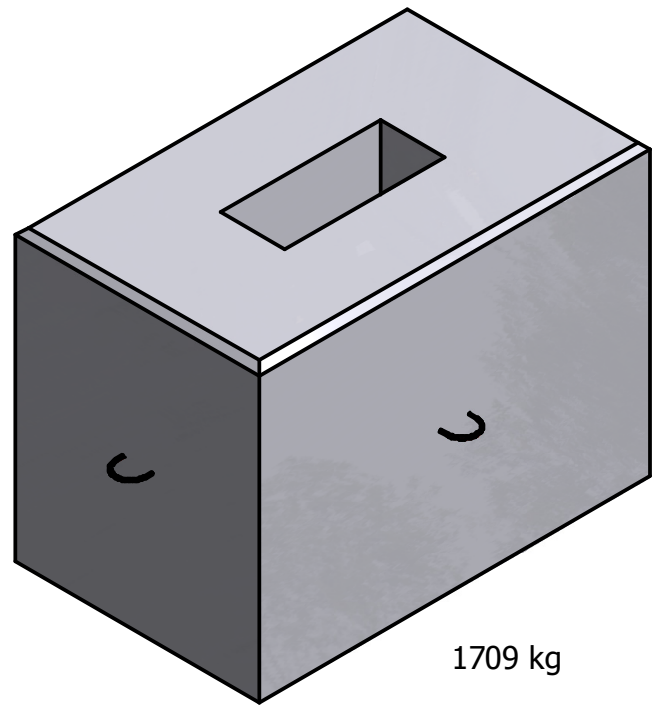

1709 kg

20 X 45°
Chamfer

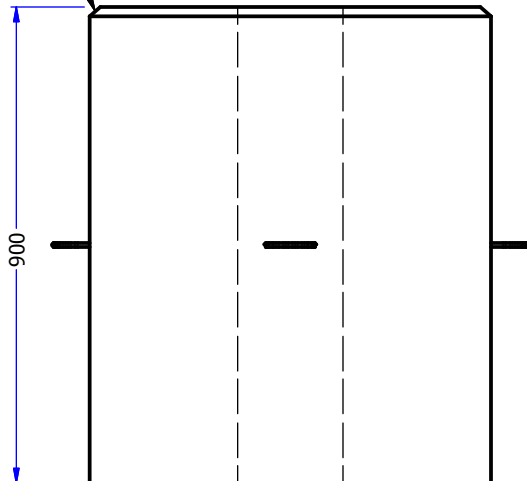

- PRODUCT MANUFACTURED IN ACCORDANCE WITH CSA A23.4
- MINIMUM CONCRETE STRENGTH AT 28 DAYS: 30 MPA
- MAXIMUM WATER-CEMENT RATIO OF 0.45 & AIR CONTENT OF 5-7%
- EXPOSURE CLASS F2/C4
- HARD STEEL FINISH
- PER MMCD DRAWING E1.2

FRASERWAY PRECAST LTD

WWW.FRASERWAYPRECAST.COM

604-534-2911

MMCD TYPE 'P' CONTROLLER BASE

SIZE	DRAWING #	15220	REV	SHEET
A	MMCD P			1/1